

# Property Report for Parcel#: 956644

Friday, November 20, 2020

## Parcel Information

Address: 7710 W TANEUM RD THORP  
Tax Parcel ID: [956644](#)  
Map Number: 18-16-01000-0014  
Recorded Area: 81.79 a  
Owner Name: BRAIN, WARREN E  
Name Cont:  
Mailing Address: 7710 TANEUM RD W  
City/State/Zip: THORP WA 98946-9526

## Critical Areas Information

Contains > 30% Slope: Yes  
PHS Site Name: N/A  
Roof Hazard: HIGH\_EXTREEME HAZARD RATING  
Roof Class: CLASS A  
Seismic Category: D1  
Shore Line: Rural Conservancy  
Wetland Code: PFOA  
DNR Water Type: Type 1, Type 4, Type 9, Type 2  
FIRM Zone: ZONE C, 100 YEAR  
FEMA Flood Map: 5300950408B  
Coalmine Shaft: N/A  
Airport Zone: N/A  
BPA Right of Way: -1  
Max Elevation: 2246  
ISO: 0.039  
PG: 88, <a href='http://www.co.kittitas.wa.us/boc/countycode/title14.aspx#14.04.020' target='\_blank'>Engineering is required</a>

## Domestic Water Information

Groundwater Permit Required? No, [Suitability Map](#)  
Qualifying Water Banks:  
Sub Basin Watershed: Taneum Creek

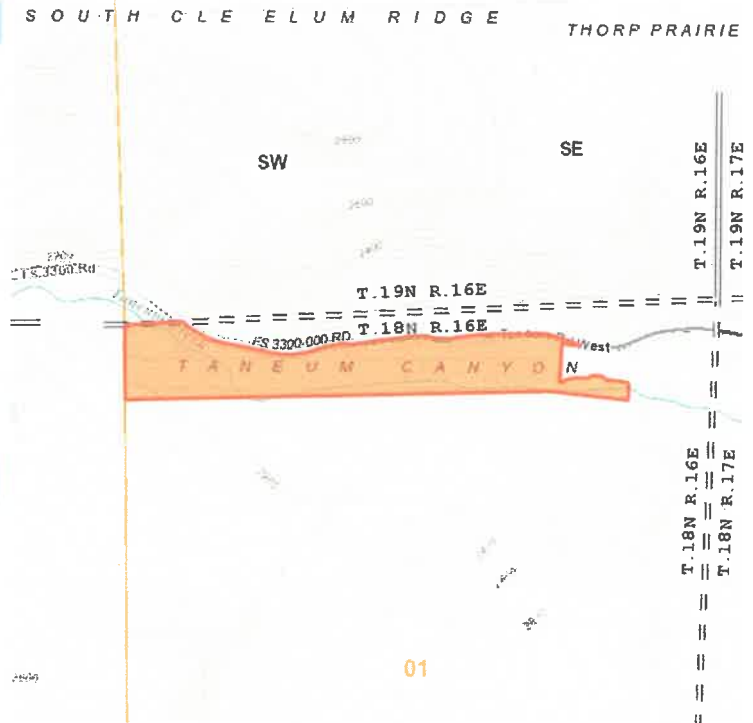

## Administrative Information

Zone and Allowed Uses: [Forest and Range](#)  
Land Use Category: Commercial Forest, [Allowed Use](#), Rural Working  
Commissioner District:  
Voter Precinct: Thorp  
Hospital District: HOSPITAL DISTRICT 1  
School District: Thorp School District  
Irrigation District: N/A  
Weed District:  
Fire District: Fire District 1 (Rural Thorp), Areas outside Fire Districts  
Cemetery District: Thorp  
Court District: Lower District Court  
PUD Comm District: District 2  
Parks and Rec District:  
Wildland Urban Interface: [IR 1](#)  
Stock Restricted Area: Open Range, Stock Restricted  
COE Gas Service Area: No